



BISHOP HELLMUTH COMMUNITY ASSOCIATION

A member of the Urban League of London



fb.com/bishophellmuth

www.bishophellmuth.org

info@bishophellmuth.org

WINTER 2016

IN THIS ISSUE

- Welcome..... 1
- What is a Heritage Conservation District? 2
- Renters:
Are You Covered?..... 2
- Useful contacts..... 2
- Property Concerns 3
- Renewing our urban forest... 3
- Coming Soon?
Rapid transit light rail line 3
- Membership Form 4

Bishop Hellmuth Community Newsletter 2016

To those new to the area, welcome!
Please consider supporting your neighbourhood community association. We are a small neighbourhood, but we have great community spirit and live within walking distance of the best London has to offer. Our district was the second to become designated as a Heritage Conservation District in the city of London.

Urban League of London and support the annual Canada Day celebration in the neighbourhood. We also maintain the community association website and facebook page. Your support helps with all of this.



Our community association meets on as-needed basis whenever there are concerns. We are also a member of the

If you interested in becoming involved with the association please write to us at info@bishophellmuth.org

Welcome to the Bishop Hellmuth Heritage Conservation District

The boundaries of the Heritage Conservation District are below, but our community extends into the heritage neighbourhoods around us:

- Grosvenor St: 272-340 (Both sides) Hellmuth Avenue: All
- Oxford Street: 280-316 (North side) St. James Street: 250-340
- Sydenham Street: 259-270 Wellington St: 765-870 (Both sides)
- Waterloo St: 754-879 (Both sides)

Our community is a rather special place to live with around 200 homes. We are all committed to a common cause, working together to ensure that we continue to look after the Bishop Hellmuth Heritage District for ourselves and future generations.

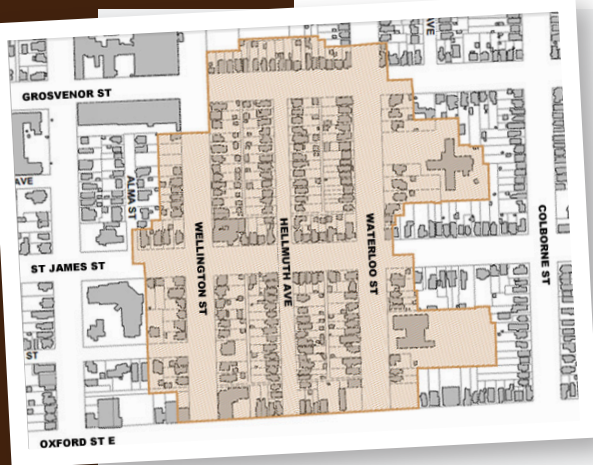

The Bishop Hellmuth Heritage Conservation District

Subscribe to our email newsletter

SUBSCRIBE ONLINE, OR BY EMAIL – DETAILS ON PAGE 4

What is a Heritage Conservation District?

A Heritage Conservation District (HCD) is an area recognized by the municipality and province as having heritage value, and is recognized by the Ontario Heritage Act. This Act provides for the protection and enhancement of groups of properties of heritage value to the community. As such, an HCD maintains the architectural integrity of a neighbourhood and helps maintain property and cultural value.

QUESTIONS ABOUT RENOVATIONS OR ALTERATIONS?

DO I NEED A PERMIT?

If you are a property owner in the HCD and are considering any exterior renovations or repairs (even minor) remember to get your 'no fee' Heritage Alteration Permit before you start to avoid delays or a 'stop work' order! Remember all houses require permits whether or not they are individually plaqued.

The Planning Dept. hopes to hire a new Heritage Planner following the retirement of Don Menard on Jan 31. In the meantime, if you have any questions contact: Kyle Gonyou at kgonyou@london.ca



The Bishop Hellmuth Community Association works to advance the interests of our heritage neighbourhood. Our activities include maintaining our heritage characteristics, interacting with city planners and property developers, as well as planning social and community events.

Renters: Are You Covered?

If you are a tenant in our neighbourhood, please make sure that your landlord has appropriate insurance coverage. The London North Community Association reports that some landlords have only regular homeowners insurance on their rental properties, and this may not provide appropriate coverage in the event of a loss. Tenants should consider getting renter's insurance to cover their personal property and should ask their landlords if they have appropriate insurance coverage.



USEFUL CONTACTS

Concerns about noise, vandalism or unruly behaviour? Call the police non-emergency line at 519-661-5670.

If there are persistent ongoing problems (noise, property damage, petty theft) call the Police COR Unit at 519-661-5983 or on duty COR cell at 519-933-1502. You can also call Glenn Matthews who is the housing mediation officer for Western and Fanshawe at 519-661-3787 if there are Student Housing problems.

By-law issues? Illegal parking, garbage or other property standards? Call the City By-Law office at 519-661-4960 (Business hours) or 519-661-4965 for after-hours. enforcement@london.ca

Animal Issues? Animal care and control at 519-685-1330 (Business hours) or 519-685-1640 for after-hours.

Full contact listing on:
[www.bishophellmuth.org/site/
community-contact-info/](http://www.bishophellmuth.org/site/community-contact-info/)

Shift London (Rapid Transit plan)
www.shiftlondon.ca

ReForest London
www.reforestlondon.ca

City of London Heritage Conservation Districts
[https://www.london.ca/
About-London/heritage/Pages/
Heritage-Conservation-Districts.aspx](https://www.london.ca/About-London/heritage/Pages/Heritage-Conservation-Districts.aspx)

Urban League of London
<http://urbanleague.ca/>

NEIGHBOURING COMMUNITY ASSOCIATIONS

**London North
Community Association**
<http://www.95lnca.com/>

Historic Woodfield
<http://www.historicwoodfield.com/>

Property Concerns

Many in the neighbourhood have expressed concern about the state of vacant houses along Oxford Street. As you know, we lost a heritage building to demolition in 2012 at the site of the current Rexall Pharmacy. "Demolition through neglect" is a phrase used to describe the practice of letting heritage buildings fall into a state of disrepair and then applying for a demolition permit. The Community Association has been in contact with the city about the houses on Oxford, and building inspectors

have been on site to ensure the buildings do not become derelict. We will alert the neighbourhood about any meetings on this topic via email and by our website.

This will also be a topic of discussion at the upcoming community meeting on March 9, 7 pm, at St. John the Evangelist Church.

COMING SOON? RAPID TRANSIT LIGHT RAIL LINE

The city has proposed a rapid transit development for London and both the provincial and federal governments have announced plans to invest in infrastructure. Although plans are not finalized, one current proposal is to build a light rail rapid transit line that will run from Fanshawe College along Oxford Street to Richmond (potentially looping through Old East and then downtown, then north on Richmond to Masonville via the university campus. Trains would run every 8 minutes. Rapid transit bus lanes would run along Richmond south to White Oaks, and west on Oxford to Wonderland. This plan is currently in the Environmental Assessment phase, with plans likely to be finalized in 2016 and the rapid transit system functional in 2020-2025.

More information can be found at www.shiftlondon.ca and particularly on the Shift London January 2016 newsletter. We encourage you to stay informed about this important development for London and share your concerns.

Renewing our urban forest

Many of the trees in our neighbourhood, and in London, are reaching an age where they need to be removed for safety reasons. Did you know that most of the trees on our front yards are property of the city? As trees are removed homeowners can request replacement trees. Visit www.reforestlondon.ca for further information on renewing our urban forest.

If you have a new tree on your property, please make sure to water it deeply especially during its first year. Getting the roots established is important. Even older trees may need water during dry summers. The ReForest London website has great information on tree care, including proper mulching. Note that piling mulch around the trunk of the tree can lead to strangler roots

and/or decay of the bark. The trunk of tree needs air exposure right down to the root collar, so mulch should be placed in a donut around the trunk, not piled up to it.

Keep your trees mulched with about 2-4 inches deep of mulch and about a half-meter around your tree. The mulch helps to keep weeds and grass from growing around the tree, retains moisture, and keeps lawn mowers and weed whackers from the tree. The best way to mulch a newly planted tree is to create a donut shape with the mulch, keeping the mulch from touching the base of the tree. You can also use a plastic O-ring to protect the tree from weed whackers and rodents. Just be sure to remove it when the tree is larger so it doesn't damage the bark.

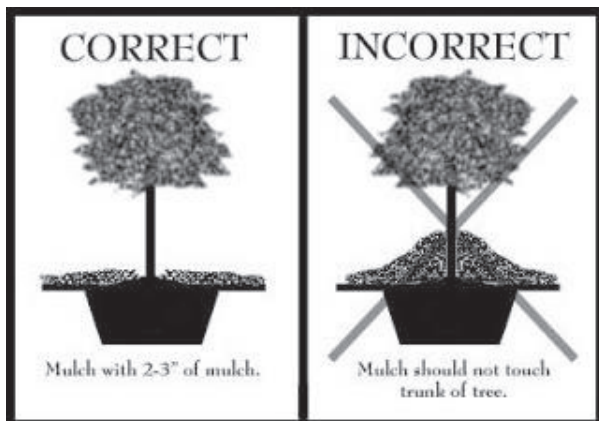

BHCA Membership Form

Please show your support for your community and its future with a membership to BHCA which enables the Association to:

- Send out newsletters and allows BHCA to keep the community informed via the website - www.bishophellmuth.org
- Invest in social events and community activities
- Deal with community issues that may arise
- Maintain our heritage characteristics, zoning and development, tenant behaviour, St. Joseph's Hospital, traffic, boulevard trees, the lanes and more
- Provide BHCA with a membership to Urban League of London

Household membership fee for one year: \$20

Please print

Name: _____ Date: _____

Address: _____

Post Code: _____

Home Phone: _____ Email*: _____

Please make cheque payable to: Bishop Hellmuth Community Association

(Mail or drop off cheques to 779 Waterloo Street N6A 3W5 or 802 Hellmuth Street N6A 3T7)

Payment can also be sent via paypal to smacdou2@uwo.ca

*(Used only for community communications)

E-MAIL NEWSLETTER

Sign up online at
www.bishophellmuth.org/site/newsletter/



[fb.com/bishophellmuth](https://www.facebook.com/bishophellmuth)

www.bishophellmuth.org



**BISHOP HELLMUTH
COMMUNITY ASSOCIATION**

A member of the Urban League of London

NEWSLETTER FROM THE BISHOP HELLMUTH COMMUNITY ASSOCIATION - 2012

REMEMBER...
subscribe to our e-mail
newsletter* and keep
abreast of all that's
happening locally...